

FUJIFILM

EPX-2500

ELECTRONIC VIDEO ENDOSCOPY SYSTEM



FUJIFILM

FUJIFILM Corporation

26-30, NISHIAZABU 2-CHOME, MINATO-KU, TOKYO 106-8620, JAPAN  
<http://www.fujifilm.com/products/medical/endoscopy/contact/>

SGE-101-01 Printed in Japan 201108-FP(DT)

# EPX-2500

Compact size processor with integrated light source.  
Realizing simple operability and high-quality images.

The EPX-2500 system is a compact processor with integrated light source, which realizes an ideal examination environment with its simple operability.

The DVI on board enables high-quality digital images to be output, providing physicians with easier image viewability.

This system is also compatible with various line-ups of FUJINON endoscopes.

## Functions of Parts

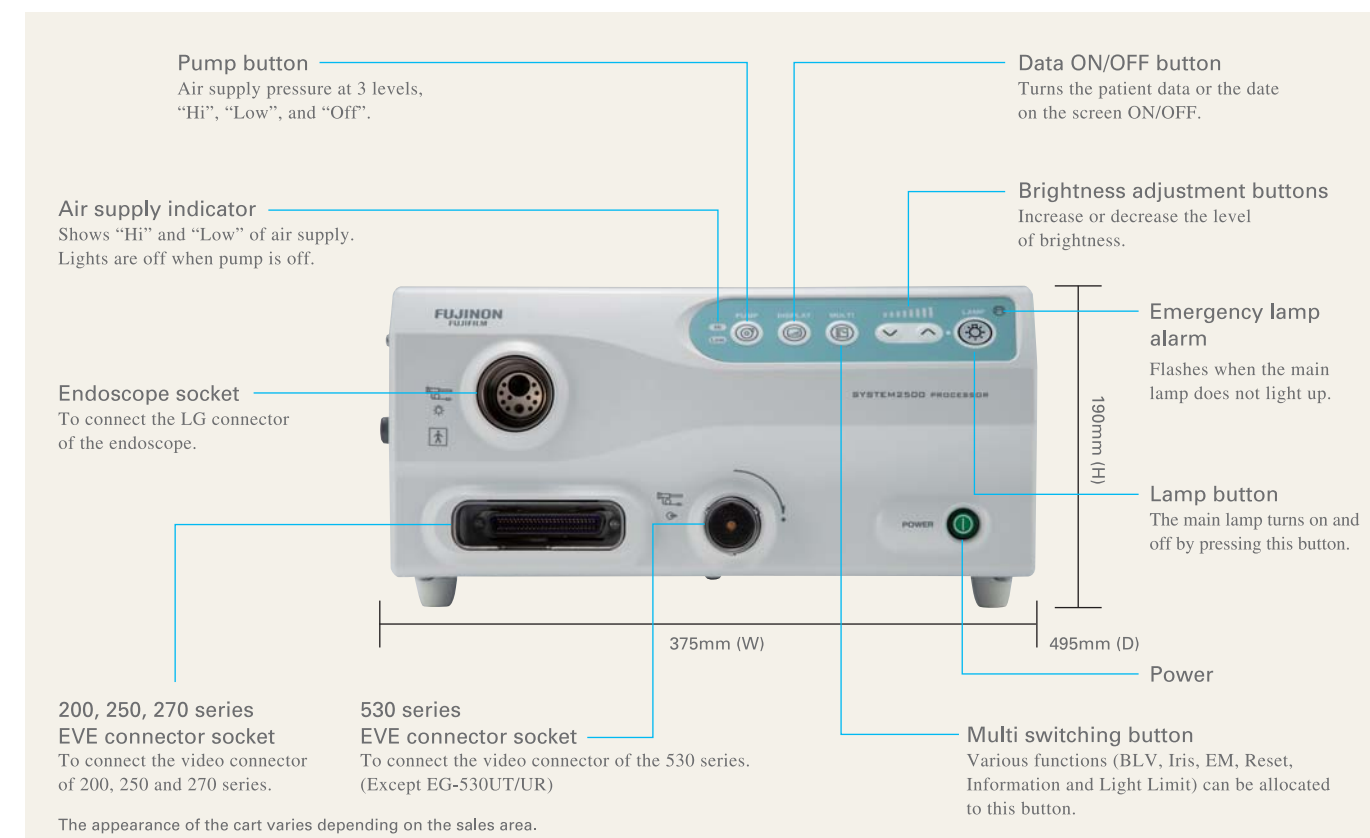

## Multi Switching Button

Frequently used functions including BLV function, Iris mode, electronic image zoom, information of the connecting scope, and light limit can be allocated to the multi switch button. This button allows you to select the function you need swiftly, leading to increased efficiency in an examination.

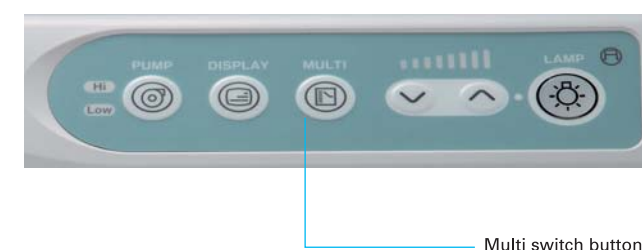

## Picture in Picture Function

The Picture in Picture function displays a real-time video image automatically in a small screen while freezing the image in the observation screen, which reassures the examination.



## DVI on-board

DVI enables digital output of a high-quality image with 1024 x 768 pixel resolution, providing a clear endoscopic image.

## Blood Vessel Enhancement Function

This function detects the subtle color changes in mucosa and vessels.

## Noise Reduction

This function reduces the noise in an image, improving the sharpness of the image.

## Compatible with a wide variety of scopes

Sockets for the 530 series and 200 series scopes are equipped. The compatibility with various endoscopes allows for the use of the best suitable scope for the clinical setting.





# Fits right. Moves agilely. Light-weight grip for high operability.

The newly developed grip fits gently into your hand, allowing full use of this high-performance endoscope.  
Materials, processing, and choice of parts have all been reviewed to reduce the grip weight  
for greater maneuverability.  
The design is improved also to allow easier cleaning and disinfection.  
G-5 GRIP and 500 SERIES SCOPE in combination offer you added amenity in routine diagnosis.



500  
SERIES  
SCOPE

G-5™  
ENDOSCOPY

## Designed Lighter & Slimmer

20% less in weight and 10mm slimmer than that of our conventional product.  
The angle operation knob is remodeled to accommodate the fingers more firmly with better fit.

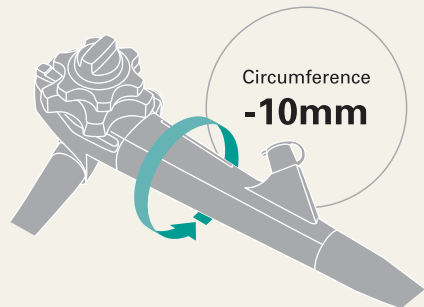

## Improved Operability

New positioning of the functional switches, Air/Water and Suction buttons minimizes finger travel and improves efficiency.



## Water Jet Function

Main endoscopes for the lower gastrointestinal tract have a water jet nozzle in addition to the forceps channel. The water jet nozzle effectively removes mucus on the surface being examined.



## Improved Cleaning and Disinfection

Cleanliness and safety focused on full defense against disinfection.  
Easily soiled Air/Water button is removable and autoclavable.  
A smoother, flatter surface assures all areas receive optimal contact with cleaning and high-performance disinfecting solutions.



## Light-weight Connector

The connectors incorporated in the 500 SERIES SCOPE are slim, lightweight, and easy to handle. Procedures are now considerably less bothersome when the endoscope has to be removed/attached for cleaning and disinfection on every occasion of endoscopy.



## Flexible Portion

In upper and lower gastrointestinal endoscopy, the great flexibility of the endoscope allows easy insertability and the comfort of the examinee to coexist, meeting on-the-scene needs.



530 SERIES UPPER GASTROINTESTINAL ENDOSCOPES

For the Upper G.I. Tract - Slim Type  
EG-530FP

EG-530FP is a slim endoscope for the upper G.I. tract having a forceps channel of 2.8mm diameter and a distal end of 8.5mm. Observation capability has been increased with a wide field of view of 140°.

Viewing direction	0°(Forward)
Field of view	140°
Observation range	3 - 100mm
Distal end diameter	8,5mm
Flexible portion diameter	8.5mm
Bending capability	UP 210° / DOWN 90° RIGHT 100° / LEFT 100°
Working length	1,100mm
Total length	1,400mm
Forceps channel diameter	2.8mm

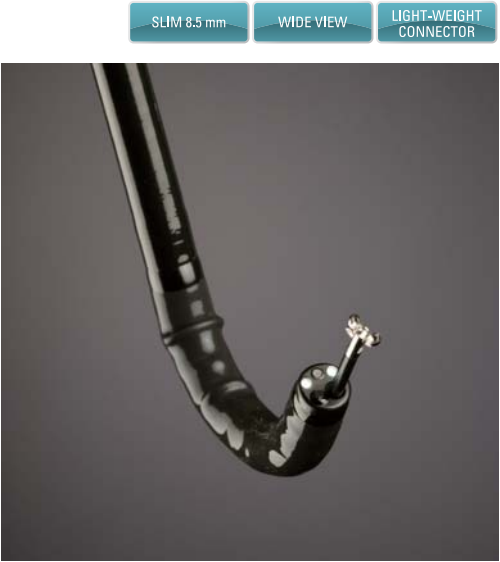
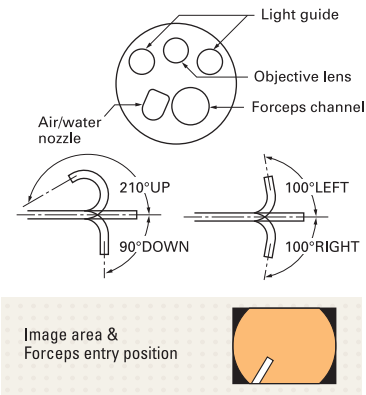

530 SERIES LOWER GASTROINTESTINAL ENDOSCOPES

For the Lower G.I. Tract - Standard Type  
EC-530FM/EC-530FI/EC-530FL

These super wide-angle standard colonoscopes offer a large 3.8mm working channel inside a slim 12.8mm outside diameter. An ultra-wide 140 degree field of view enhances image quality from the center to the edge. These colonoscopes also offer a wider observation range from 3-100mm. In addition, an integrated forward water jet allows for lavage in clinical situations.

	FM	FI	FL
Viewing direction	0°(Forward)		
Field of view	140°		
Observation range	3 - 100mm		
Distal end diameter	12.8mm		
Flexible portion diameter	12.8mm		
Bending capability	UP 180° / DOWN 180° RIGHT 160° / LEFT 160°		
Working length	1,330mm	1,520mm	1,690mm
Total length	1,630mm	1,820mm	1,990mm
Forceps channel diameter	3.8mm		

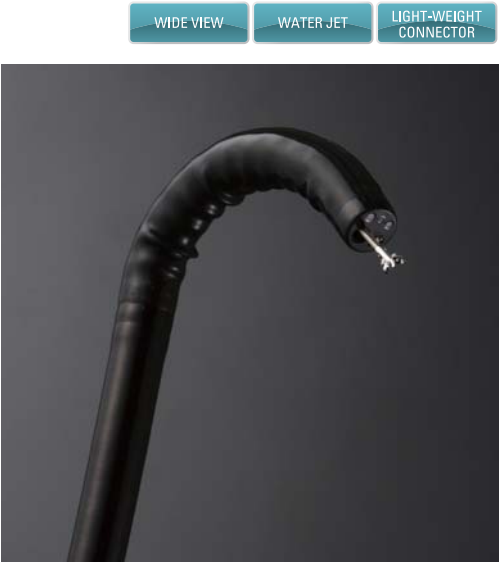
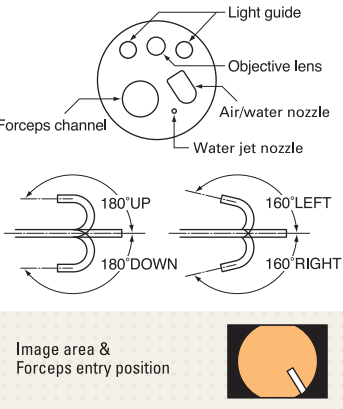

EXAMPLE OF SYSTEM CONFIGURATION

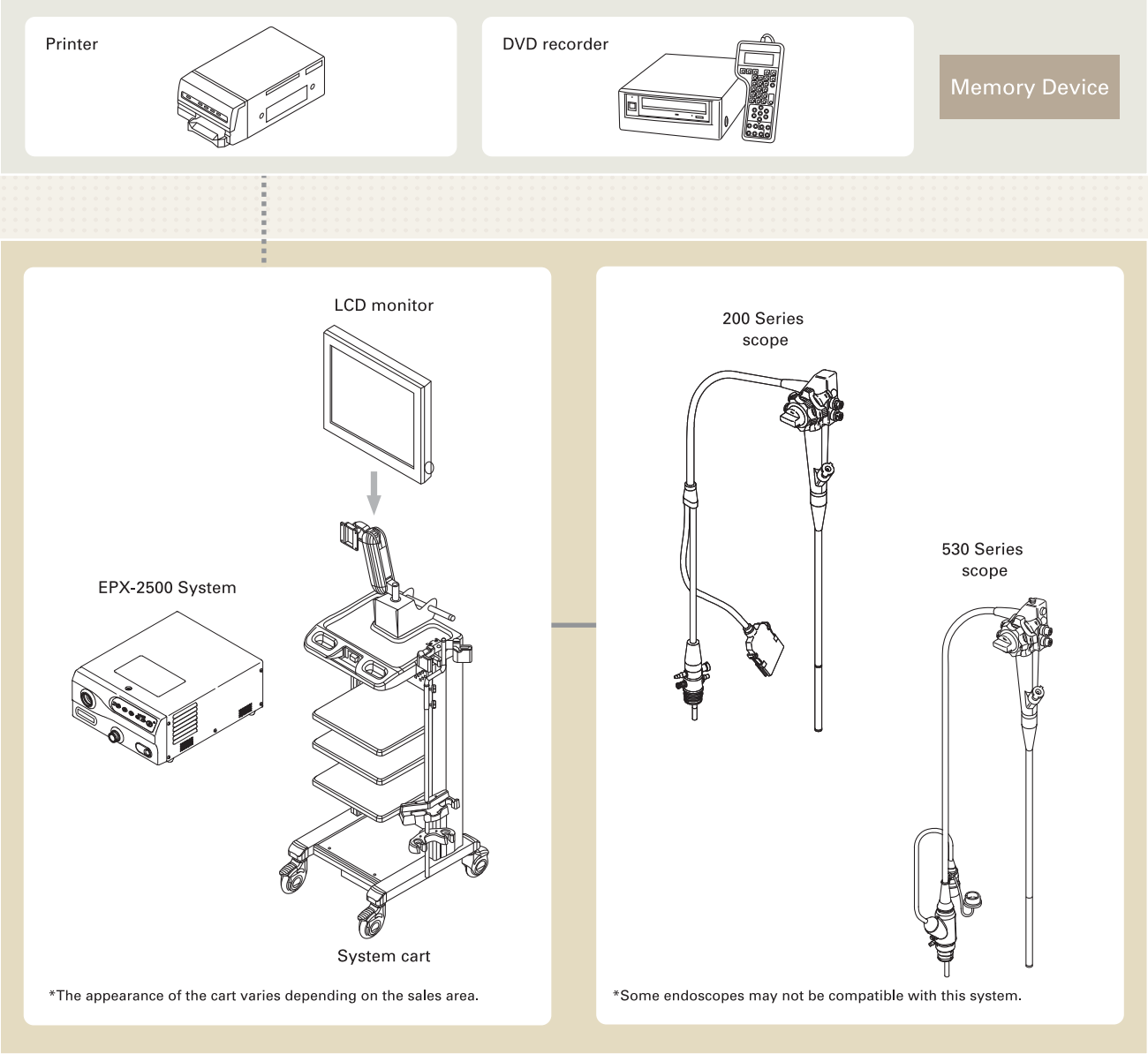

EPX-2500

Specifications

Digital output	DVI (Digital Visual Interface) : 1024x768p
Analog output	RGB (2) : SDTV (NTSC/PAL) Y/C (2) : SDTV (NTSC/PAL) Composite : SDTV (NTSC/PAL)
Color adjustment	Black, Red, Green, Blue, R-Hue, Chroma; 9 settings
Detail	Hi, LO; 9 settings
Contrast (gamma)	9 settings
BLD	Hi, Mid, Lo, Off
Picture in Picture	On, Off; Size : 1/4, 1/3
Auto gain control	Off, +3db, +6db
Iris	Average / Peak

Zoom	Electric zoom : x1.0 - x2.0; 0.05 steps
Lamp rated value	Main lamp : 11.7V 150W Xeon lamp Emergency lamp : 12V 75W Halogen lamp
Brightness control	9 settings
Lamp cooling method	Forced air cooling
Air supply pump	Hi, Low, Off
Power	120V 60Hz 2.7A / 230V 50Hz 1.4A
Dimensions (WxHxD)	375 x 190 x 495mm (including projections)
Weight	17.0kg